

C-MOUNT LENS SPOT LIGHT

SP-26-CM

Precise spot illumination
as a combination of a robust,
strong Spot Light and a C-mount lens.

C-MOUNT LENS OF YOUR CHOICE

INTEGRATED LIGHT INTENSITY REGULATION

INTERNAL, EXTENDED STROBE PULSE TIMING

HOMOGENEOUS ILLUMINATION WITHOUT UNDESIRABLE HALO EFFECTS



LIGHT OPERATING MODES

PERMANENT ILLUMINATION MODE

This light is designed for both the permanent and light-triggering mode. For permanent illumination bring the voltage of 12-24 V to the pin number 4 (black wire). The light is ON during the time when the 24 V EN signal is activated. Use a PCL, camera or another binary signal source. For the light intensity control, please see the text below.

LIGHT TRIGGERING MODE

Light triggering mode saves energy and extends the lifetime of the light. Trigger operation mode is recommended when a parallel operation of 2 or more lights might affect the quality of the acquired image. To start using a triggering mode, bring the pin number 4 (black wire) to a 12-24 V signal. The light is ON when a voltage signal is present at pin number 4 then. Use a PCL, camera, or another binary signal source for triggering. For the light intensity control, please see the text below.

STROBE MODE

Strobe function significantly multiplies the maximum intensity of the light. The strobing function saves energy, extends the light lifetime and in many cases improves the stability of the entire inspections system. Pin number 2 (white wire) of the M8 connector is used to activate the strobe function. The maximum strobe pulse time is 470 ms, while the light idle time must be at least 3 times longer. Please do not use a trigger mode during strobing function, do not bring a voltage to the pin number 4.

LIGHT SOURCE INTENSITY REGULATION

The light intensity might be regulated by an internal trimmer, PWM signal or an external controller. The maximum PWM frequency is ≤ 40 kHz.

WAYS OF USE

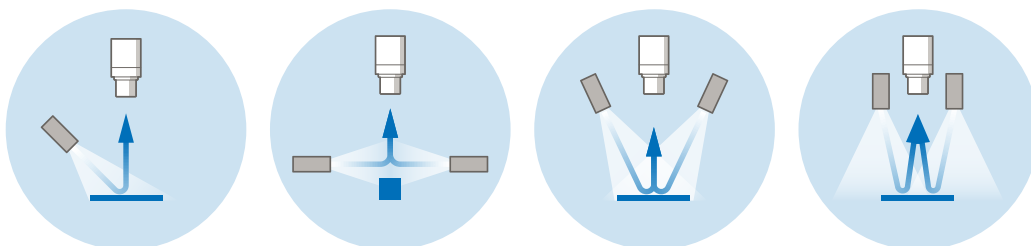

*Applies for devices with wavelength UV405, UV395, UV385 and UV365. This type of a light has a source of ultra violet radiation. Avoid direct exposure of eyes and unprotected parts of skin. Install the light in a safe way to avoid accidental or deliberate damage of unprotected human skin by UV light radiation. Mark room/area of use with a warning sign.

ORDERING CODE

example of the ordering code

SP - 26 B - CM

Spot Light Ø of Active Area Wavelength C-mount lens thread

CONFIGURATION

Model	Wavelength [nm]	Ø of Active Area [mm]	Function
SP-26W	CTR 5700 K	26	4S
SP-26HIR	940	26	4S
SP-26IR	850	26	4S
SP-26HR	660	26	4S
SP-26R	625	26	4S
SP-26G	525	26	4S
SP-26B DB	470 450	26	4S
SP-26UV	405 395 385 365	26	4S

ELECTRIC PARAMETERS

Model	SP-26W	SP-26HIR	SP-26IR	SP-26HR	SP-26R	SP-26G	SP-26B DB	SP-26UV
U_n	12-28 V	12-28 V	12-28 V	12-28 V	12-28 V	12-28 V	12-28 V	12-28 V
U_{jm}	24 V	24 V	24 V	24 V	24 V	24 V	24 V	24 V
I_{jm}	150 mA	150 mA	150 mA	150 mA	150 mA	150 mA	150 mA	125 mA
P	3.6 W	3.6 W	3.6 W	3.6 W	3.6 W	3.6 W	3.6 W	3 W

U_{trig}	Trigger Voltage	≥ 10 - 24 V ²	I_{trig}	Trigger Current	2.3 mA ²	I_{EN}	PWM Dimming	> 10 V .. ≤ 24 V ¹
U_{str}	Strobe Voltage	3 - 24 V ³	I_{str}	Strobe Current	1.9 mA ³			

¹ PWM maximal rate is ≤ 40 kHz ² EN (Enable) trigger signal values, M8 connector - pin number 4 ³ Driving voltage and current M8 connector - pin number 2

DIMENSIONS & WEIGHT

A	Length [mm]	32
B	Width [mm]	32
C	Height [mm]	72
	Weight [g]	136

 For more details please see our 2D drawings.

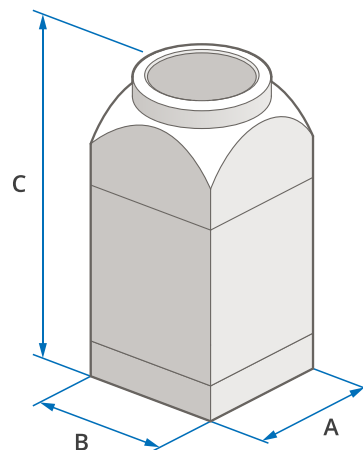

TECHNICAL DATA

IP Category: IP50	Protection Category: III	Ambient Temperature: -20 - +40 °C	Isolation Resistance: 500 V	Housing Material: Aluminium alloy
--------------------------	---------------------------------	--	------------------------------------	--

LENSES WITH DIFFERENT TYPES OF FOCUS LENGTH

Wide angle lenses (large lighting spot)

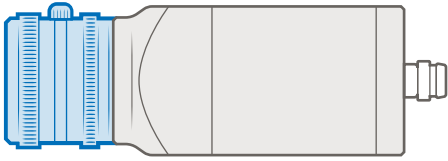

Standard & telephoto lenses (small lighting spot)

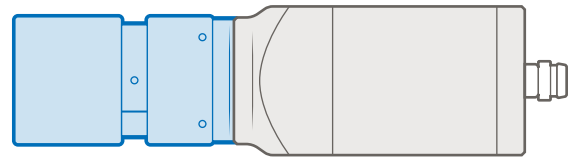

LENS FOCUS

Adjust your lens focus so that, there is a **homogenous lighting spot in the entire illuminated area.**

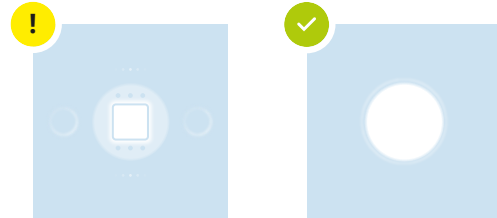

CONNECTOR M8-4PIN ASSIGNMENT

light connector front view

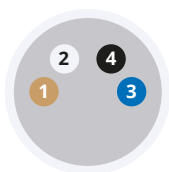

1	Brown	+	+24 V
2	White		EN
3	Blue	-	0 V
4	Black		EN

...

2 ENABLE - strobe mode (+24 V)

...

4 ENABLE

A permanent lighting or trigger signal (10-24 V)

B intensity regulation: PWM \leq 40 kHz

C light intensity regulation: internal trimmer

ACCESSORIES

✓ Straight Cable M8-4PIN (5 m)

OPTIONAL ACCESSORIES

+ Angular Cable M8-4PIN (5 m)

+ C-mount lenses with different focus lengths

+ Light Polarization

+ Controller **Smart Light CT-SL4D**

+ Controller **CM-01**

 SmartView

**YOUR
VISION
PARTNER**

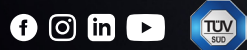

**COMPANY
OFFICE**

Smart View s.r.o.
Nivy 313
765 02 Otrokovice
Česká republika

+420 601 575 797
+420 602 457 497

info@smartview.cz
www.smartview.cz

**OUR SALES PARTNERS
SLOVAKIA**

MTS, spol. s r.o.
Krivá 53
027 55 Krivá
Slovensko

+421 43 5819 111

mts@mts.sk
www.mts.sk